

700 N. BRAND
12TH FLOOR
700 N. BRAND BLVD.
GLENDALE, CA 91203

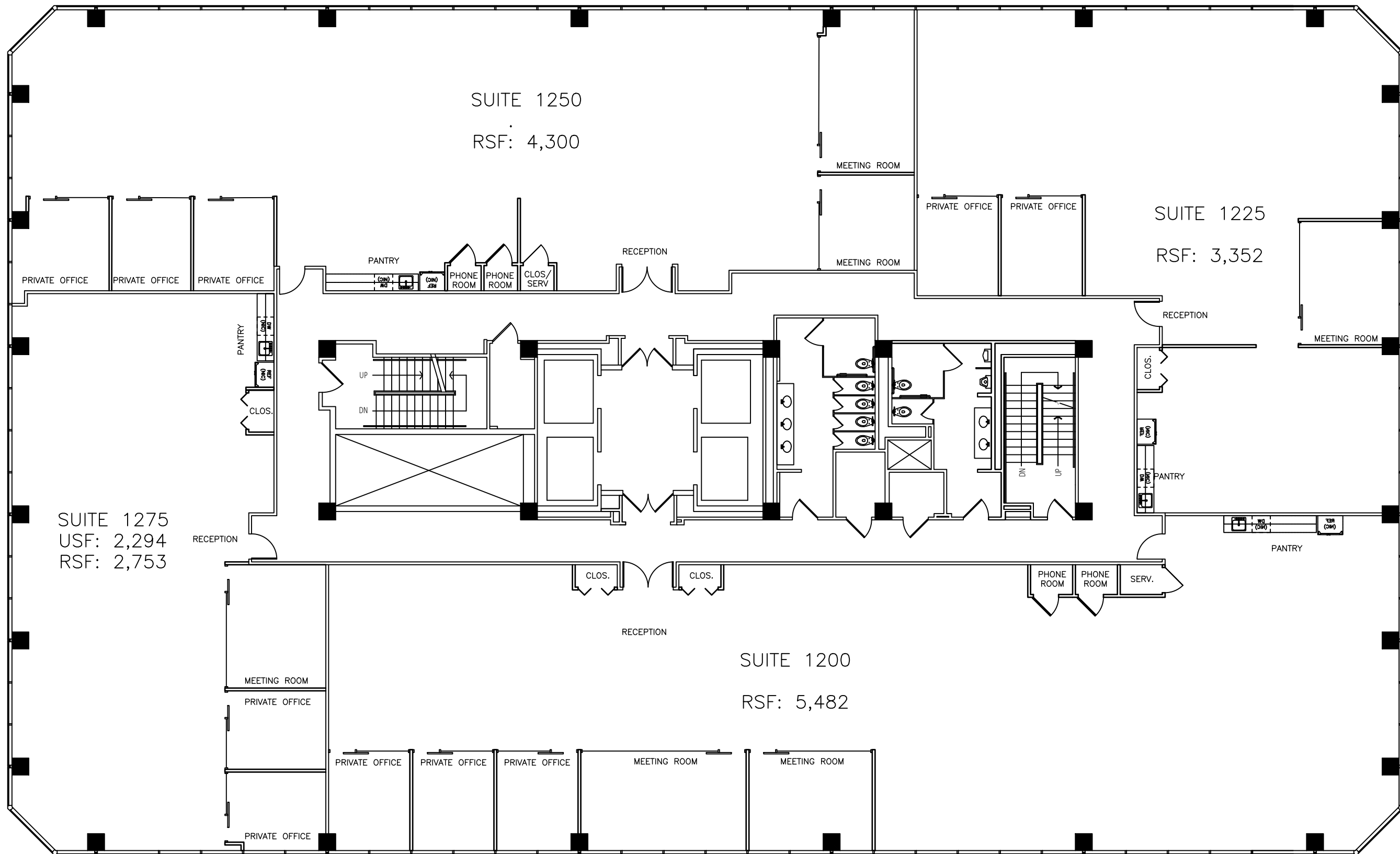

ISSUE: 11/3/2017

REVISIONS:

NO.	DESCRIPTION

SCALE:

LEGEND:

- DRYWALL
- GLAZING
- GLASS SLIDING DOOR
- GLASS SWING DOOR
- HOLLOW CORE WOOD DOOR
- WOOD DOOR W/ GLASS INSERT
- BIFOLD WOOD DOOR

SHEET TITLE:

FLOOR PLAN

SHEET:

ID1.01

700 N. BRAND
12TH FLOOR
700 N. BRAND BLVD.
GLENDALE, CA 91203

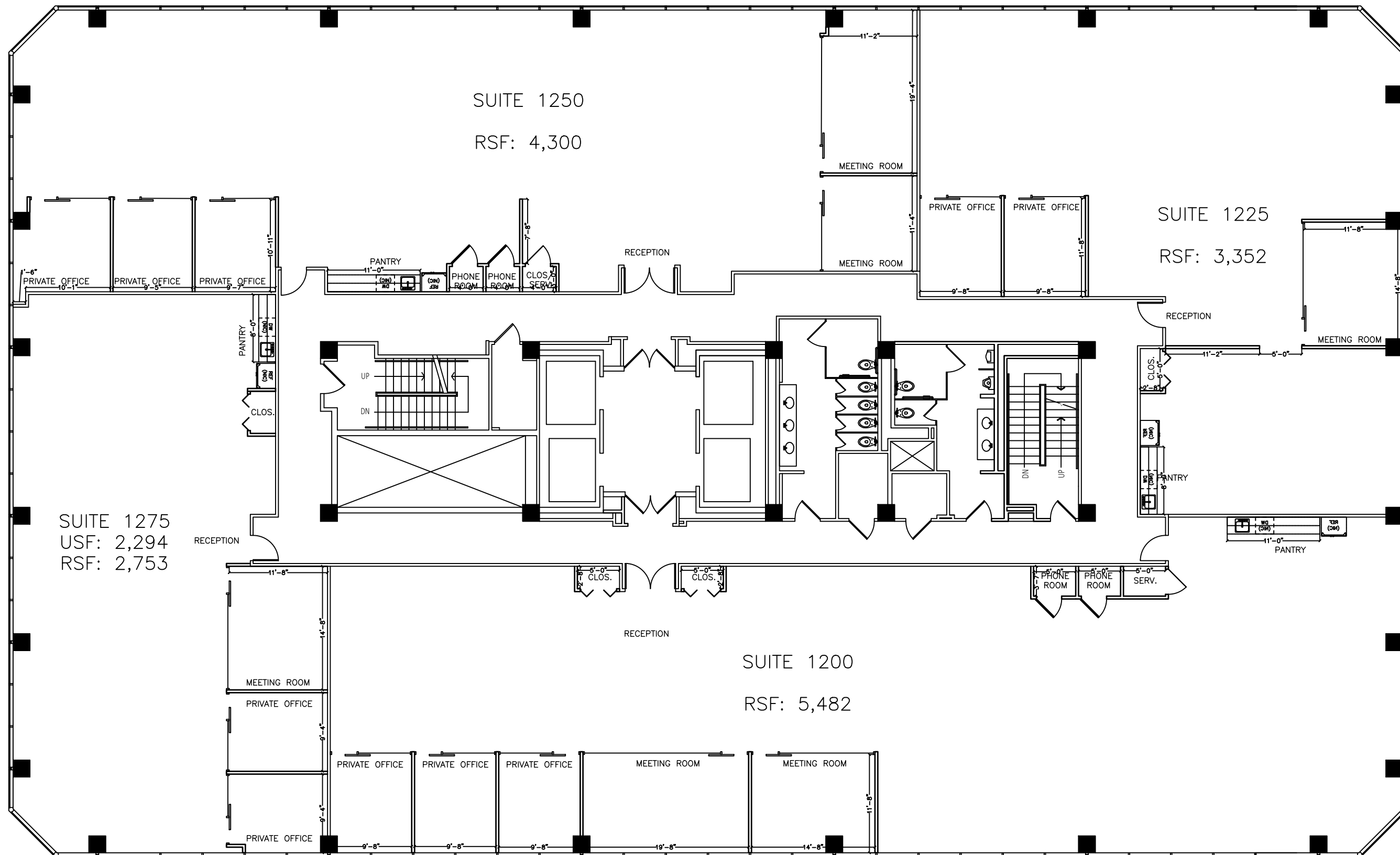

ISSUE: 11/3/2017

REVISIONS:

NO.	DESCRIPTION	DATE

SCALE:

LEGEND:

- DRYWALL
- GLAZING
- GLASS SLIDING DOOR
- GLASS SWING DOOR
- HOLLOW CORE WOOD DOOR
- WOOD DOOR W/ GLASS INSERT
- BIFOLD WOOD DOOR

SHEET TITLE:

DIMENSIONED
FLOOR PLAN

SHEET:

ID1.02

700 N. BRAND
12TH FLOOR
700 N. BRAND BLVD.
GLENDALE, CA 91203

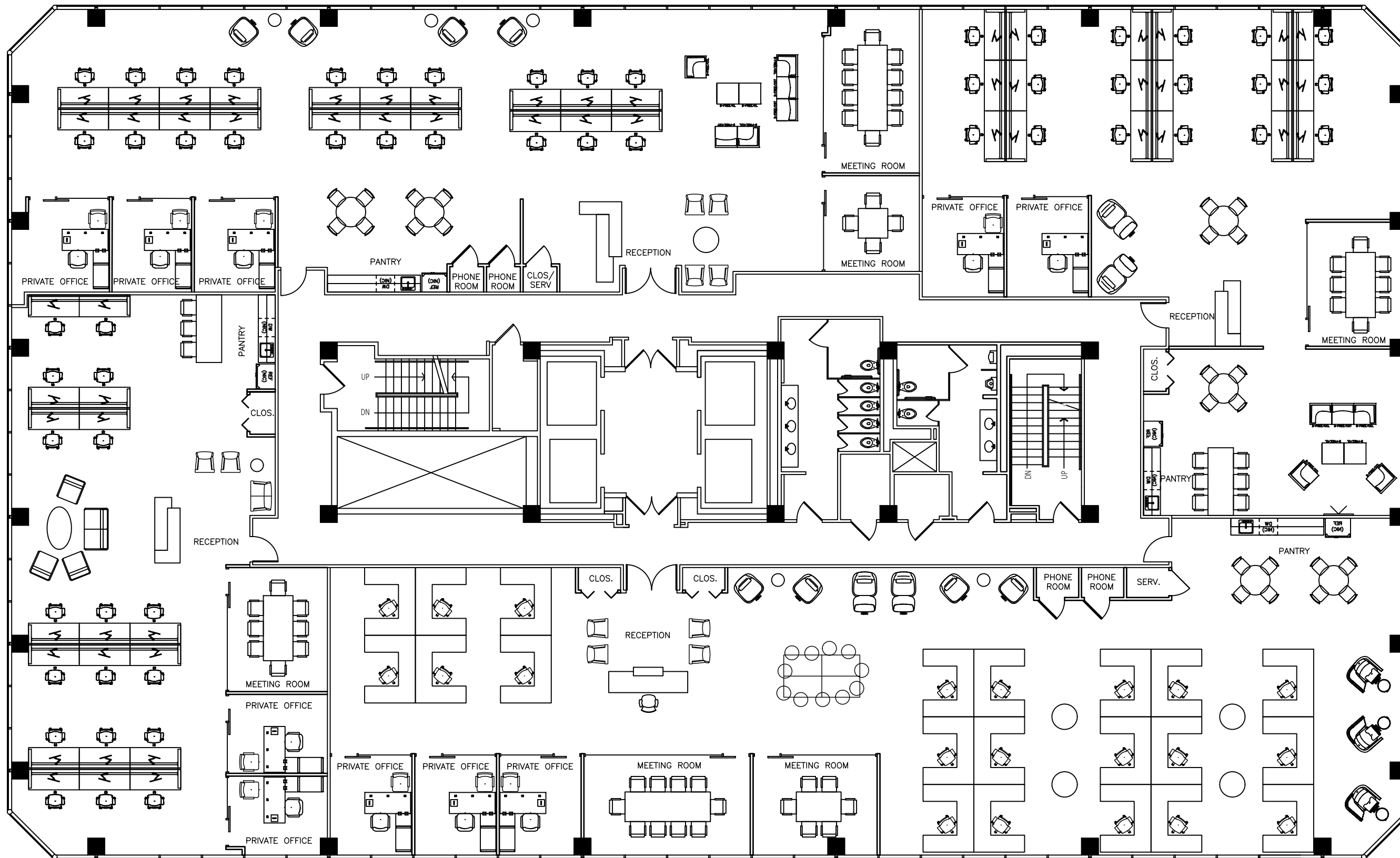

ISSUE: 11/3/2017

REVISIONS:

NO.	DESCRIPTION

SCALE:

LEGEND:

- DRYWALL
- GLAZING
- GLASS SLIDING DOOR
- GLASS SWING DOOR
- HOLLOW CORE WOOD DOOR
- WOOD DOOR W/ GLASS INSERT
- BIFOLD WOOD DOOR

SHEET TITLE:

FURNITURE PLAN

SHEET:

ID1.03