



OLD TOWN PARK

PHASE 2 AND PHASE 3 - RETAIL FOR LEASE

For more information,
please contact:

DANNY JACOBSON
Danny.Jacobson@cbre.com

STEPHEN ANSANI
Stephen.Ansani@cbre.com

onni® + **CBRE**
group

FLOOR PLAN

PHASE 2

OLD TOWN PARK



SITE ATTRIBUTES:

- New construction 428 unit residential building
- 1,500+ residential units on site
- Well Street frontage with outdoor seating
- Excellent signage opportunity
- Dramatic ceiling heights over 13'-2" feet
- Immediate Delivery

For more information,
please contact:

DANNY JACOBSON
Danny.Jacobson@cbre.com

STEPHEN ANSANI
Stephen.Ansani@cbre.com

onni group + **CBRE**

FLOOR PLAN

PHASE 3

OLD TOWN
PARK

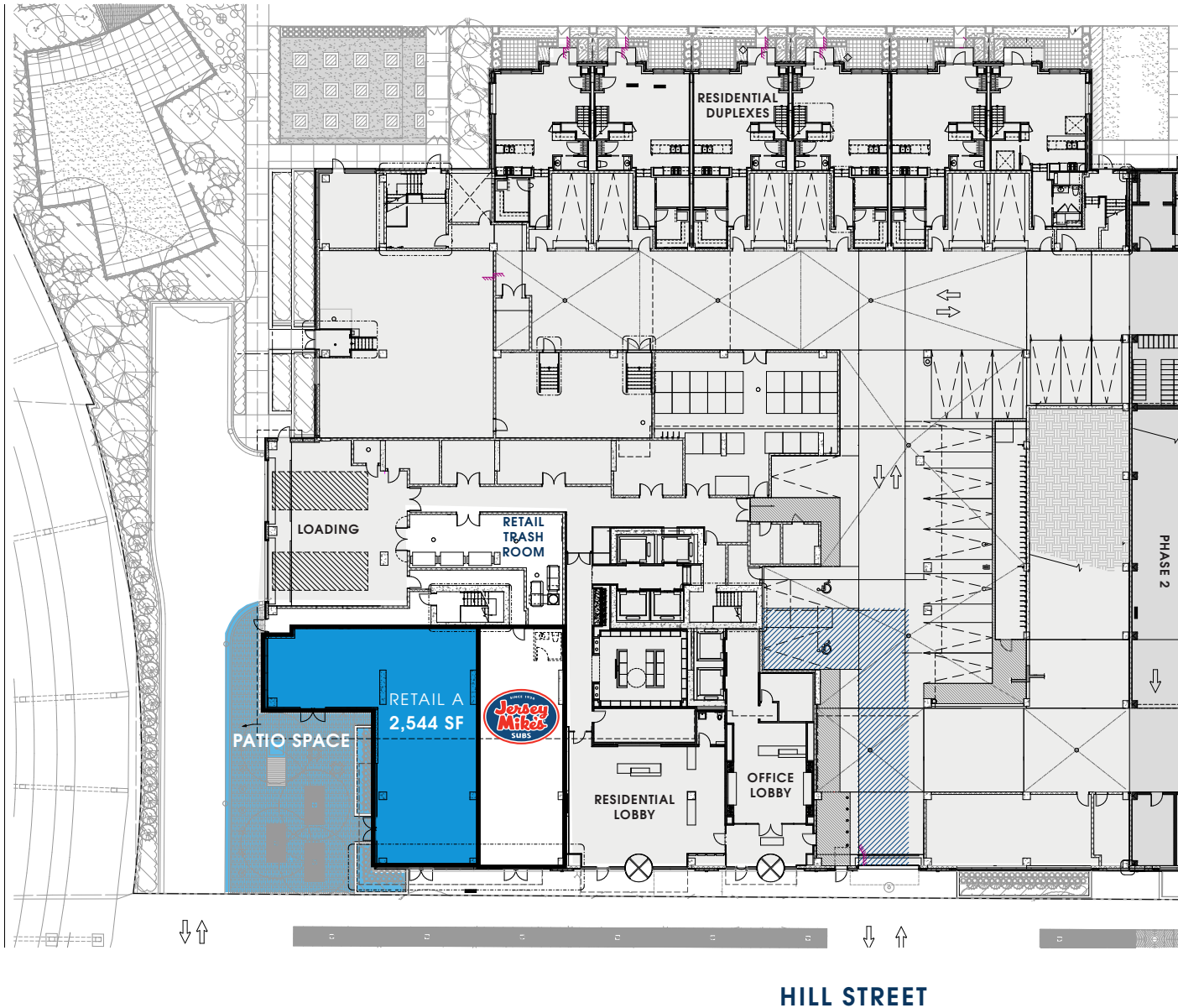

SITE ATTRIBUTES:

- 2,544 SF within the third residential tower with 456 residential units.
- 1,500+ residential units on site
- 70,114 SF of office space
- Excellent signage opportunities
- Dramatic ceiling heights over 13'-2" feet
- Available immediately

For more information,
please contact:

DANNY JACOBSON
Danny.Jacobson@cbre.com

STEPHEN ANSANI
Stephen.Ansani@cbre.com

onni group + **CBRE**

SITE PLAN

228 WEST HILL STREET

OLD TOWN
PARK

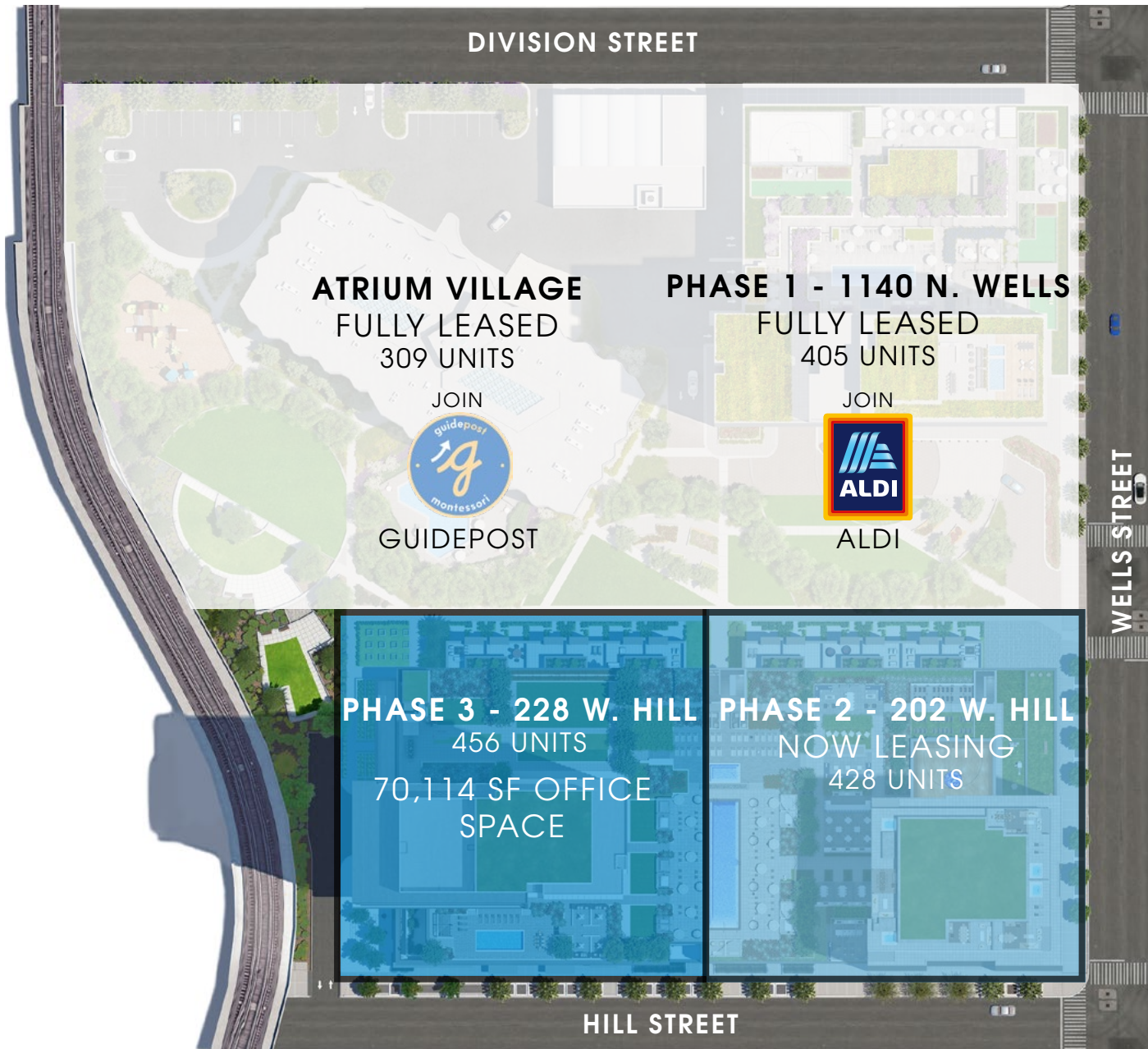

PROPERTY HIGHLIGHTS:

- Located along the heavily trafficked Wells Corridor, in the heart of the Old Town neighborhood at the northwest corner of Wells & Hill
- Convenient access to all other North Side neighborhoods including Gold Coast, River North, Old Town, River West, Wicker Park & Bucktown
- Neighboring retailers include Jewel-Osco, Target, Mariano's, Plum Market, SoulCycle, Starbucks, Panera, Dick's Sporting Goods, Happy Camper, Row House, AT&T & more
- Ideal for restaurants, fitness, service users, medical and a wide variety of other retailer tenants

For more information,
please contact:

DANNY JACOBSON
Danny.Jacobson@cbre.com

STEPHEN ANSANI
Stephen.Ansani@cbre.com

onni + **CBRE**
group

OLD TOWN RETAIL AND RESTAURANT CORRIDOR

- 1959 KITCHEN & BAR
- 80 PROOF
- ADOBO GRILL
- BENCHMARK
- BROKEN ENGLISH TACO
- BURTON PLACE
- BUZZ BAIT TAQUERIA
- CAFÉ SUSHI
- CHINA DOLL
- CORCORAN'S GRILL & PUB
- DINOTTO
- DOG HOUSE GRILL
- FORASTERO
- HAPPY CAMPER
- HASHBROWNS CAFÉ
- KAMEHACHI
- LADY GREGORY'S BAR
- MAMA MILANO PIZZA BAR
- NOOKIES
- OLD JERUSALEM

- OLD TOWN ALE HOUSE
- OLD TOWN POUR HOUSE
- OLD TOWN SOCIAL
- OPTIMA
- ORSO'S
- SMALL CHEVAL SUITE LOUNGE
- THE FIREPLACE INN
- THE GLUNZ TAVERN
- THE RABBIT HOLE
- THE SEDGWICK STOP
- THE VIG
- TOPO GIGIO
- TWIN ANCHORS
- TWO LIGHTS SEAFOOD AND OYSTER
- WELLS ON WELLS
- WOODIE'S FLAT

North Ave



FOXTROT

Latin School of Chicago 1,175 STUDENTS



OLD TOWN

LaSalle St

Clark St

GOLD

Schiller St

COAST

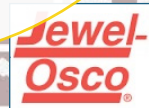

Goethe S



NEWCITY

LIFESTYLE & ENTERTAINMENT DISTRICT

- DICK'S SPORTING GOODS
- James & Sons Fine Jewelers
- Capital One
- AT&T
- FAIGHT
- LOVESAC
- Nando's
- mudsho
- KINGS
- MARIANOS
- Luxury Eyeglass

Clybourn Ave



DIVISION STREET



CTA RIDERSHIP - 2.5 MILLION ANNUALLY



NEAR

Immaculate Conception - St. Josephs School 450 STUDENTS



Walter Payton College Prep 1000+ STUDENTS



Oak St



Larrabee St

NORTH

WELL STREET

AVG. HOUSEHOLD INCOME



0.5 MILE \$111,440
1.0 MILE \$132,127

DAYTIME POPULATION



0.5 MILE 33,889
1.0 MILE 160,532

RESIDENTIAL POPULATION



0.5 MILE 31,809
1.0 MILE 81,469

For more information, please contact:

DANNY JACOBSON
Danny.Jacobson@cbre.com

STEPHEN ANSANI
Stephen.Ansani@cbre.com



CONTACT

DANNY JACOBSON

312.935.1901

Danny.Jacobson@cbre.com

STEPHEN ANSANI

312.935.1907

Stephen.Ansani@cbre.com



OLD TOWN PARK



© 2021 CBRE, Inc. All rights reserved. This information has been obtained from sources believed reliable, but has not been verified for accuracy or completeness. Any projections, opinions, or estimates are subject to uncertainty. The information may not represent the current or future performance of the property. You and your advisors should conduct a careful, independent investigation of the property and verify all information. Any reliance on this information is solely at your own risk. CBRE and the CBRE logo are service marks of CBRE, Inc. and/or its affiliated or related companies in the United States and other countries. All other marks displayed on this document are the property of their respective owners. Photos herein are the property of their respective owners and use of these images without the express written consent of the owner is prohibited.