

FOR LEASE | RETAIL

611 NORTH BRAND

Glendale, CA 91203





PROPERTY HIGHLIGHTS/ FLOORPLAN

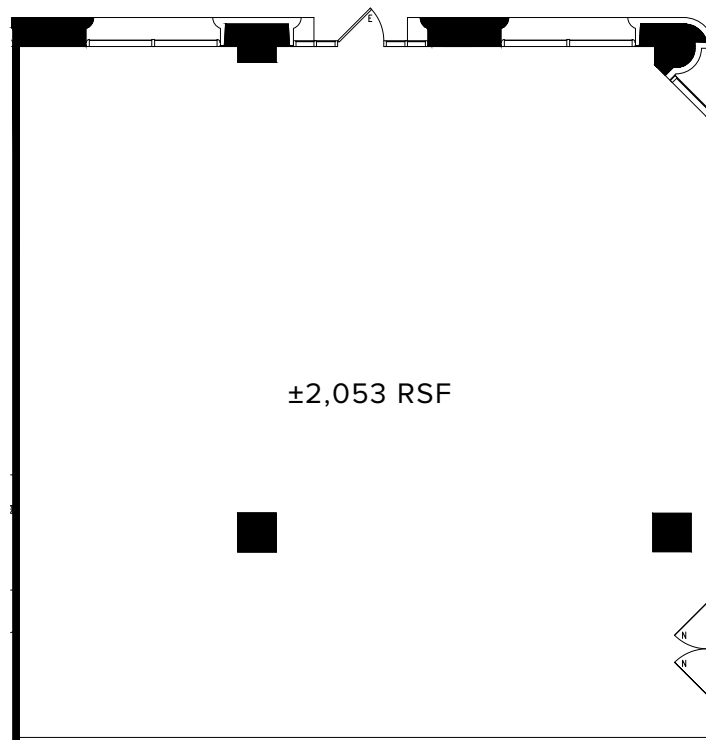

- **±2,053 RSF Retail space available**
 - **Owned and managed by Onni Group**
 - **Convenient access to the 134 and 5 freeways**
 - **Tenant amenity lounge and fitness center**
 - **Close proximity to Hollywood Burbank Airport**
 - **Located in the bustling Downtown Glendale district**
 - **On-site management with 24/7 security**
 - **Central to numerous restaurants and retail amenities within Downtown Glendale, Glendale Galleria, Americana at Brand, and various mixed-use retail and entertainment developments**
 - **Parking ratio of 3.00/1,000**
- RSF leased at:**
- **\$105.00 per unreserved stall/mo.**
 - **\$145.00 per reserved stall/mo.**

AERIAL / DEMOGRAPHICS

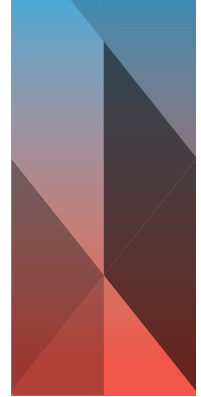

	1 MILE	3 MILES	5 MILES
Population	62,370	209,137	513,522
Daytime Population	85,426	230,756	544,552
Average HH Income	\$99,856	\$114,431	\$128,083

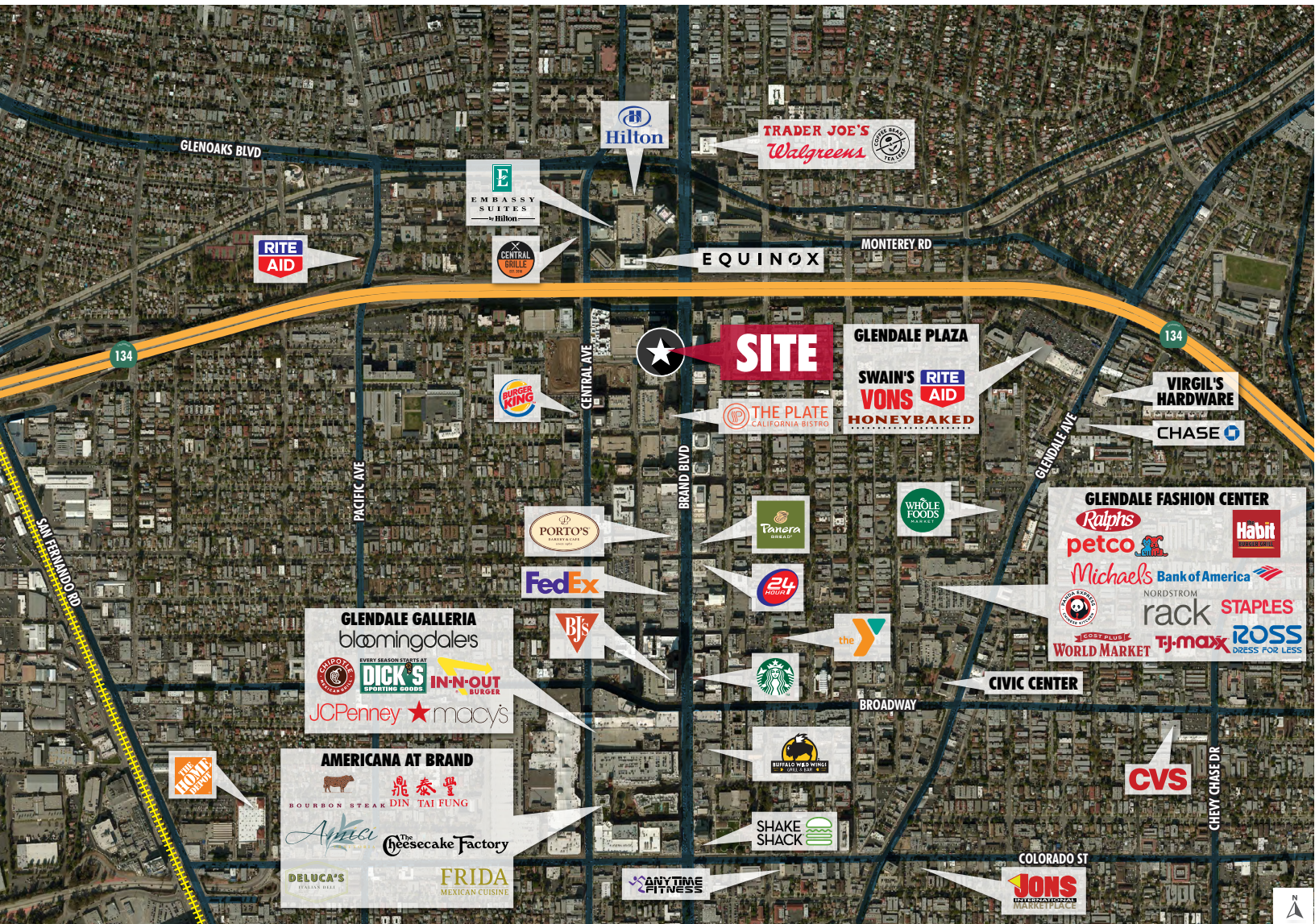

611 NORTH BRAND

Glendale, CA 91203



PLEASE CONTACT:

Geoff Martin

Senior Vice President
+1 818 502 6739
geoff.martin@cbre.com
Lic. 01180819

Ryan Burnett

First Vice President
+1 818 502 6791
ryan.burnett@cbre.com
Lic. 01481691

Brian Yoshimura

Sales Assistant
+1 818 502 6736
brian.yoshimura@cbre.com
Lic. 01967227

© 2023 CBRE, Inc. All rights reserved. This information has been obtained from sources believed reliable but has not been verified for accuracy or completeness. CBRE, Inc. makes no guarantee, representation or warranty and accepts no responsibility or liability as to the accuracy, completeness, or reliability of the information contained herein. You should conduct a careful, independent investigation of the property and verify all information. Any reliance on this information is solely at your own risk. CBRE and the CBRE logo are service marks of CBRE, Inc. All other marks displayed on this document are the property of their respective owners, and the use of such marks does not imply any affiliation with or endorsement of CBRE. Photos herein are the property of their respective owners. Use of these images without the express written consent of the owner is prohibited.